

Quick Setup

IMPORTANT: Before using this product, make sure you read these instructions and the safety instructions in the online *User's Guide*.

Note: *These illustrations show the PowerLite 994F, but the instructions are the same for the PowerLite 1290 unless otherwise noted.*

Contents

Make sure your projector box includes all of these parts:

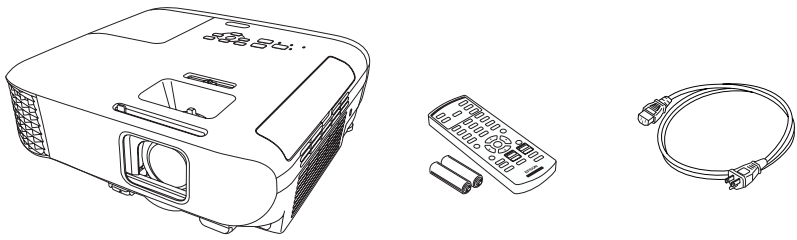

Connect the projector

Choose from the following connections. See the sections below or the online *User's Guide* for details.

Computer

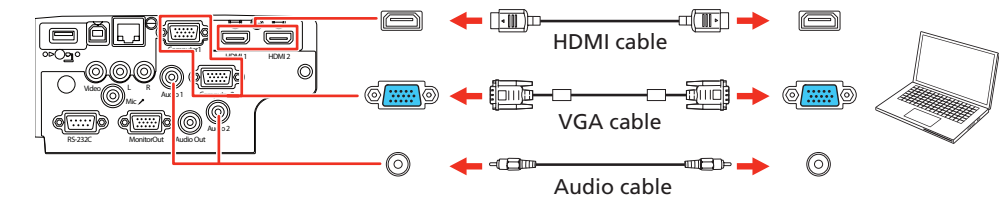

HDMI™ port

Connect one end of an HDMI cable to one of the projector's **HDMI** ports and the other end to an HDMI port on your computer.

Computer port (PowerLite 994F)

Connect one end of a VGA cable to one of the projector's **Computer** ports and the other end to your laptop or computer's monitor port. Make sure to switch your laptop to external display (see "Troubleshooting" on the back of this sheet). You can also connect an audio cable.

Video device

Connect multiple video devices and use the **Source Search** button on the projector or remote control to switch between them.

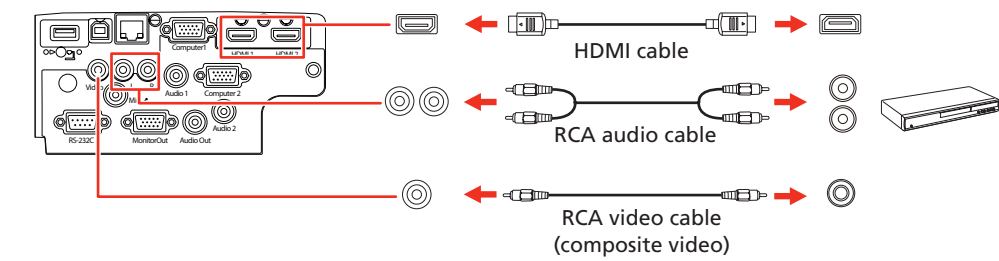

Note: *If you connected a streaming device to an HDMI port, you can also connect it to the projector's **USB-A** (flat) port for power.*

Wired network (PowerLite 994F)

Connect the projector to your network using an Ethernet cable. See the online *User's Guide* for details.

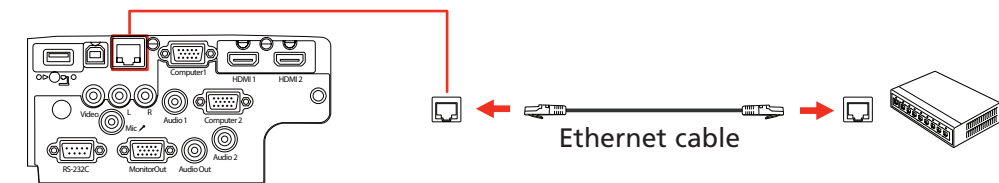

USB device

Connect a supported digital camera, USB flash drive, or USB storage device to the projector's **USB-A** (flat) port.

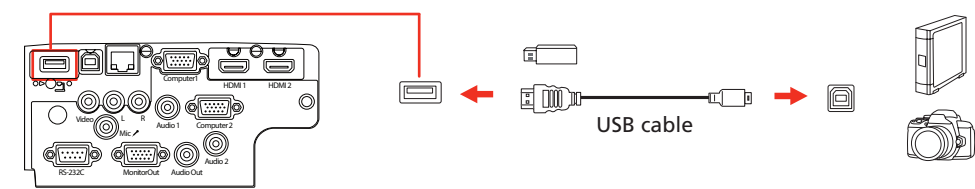

If you connect a digital camera, USB flash drive, or USB storage device, you can use the projector's PC Free feature. See the online *User's Guide* for details.

Using the remote control

Install the batteries as shown (two AA batteries).

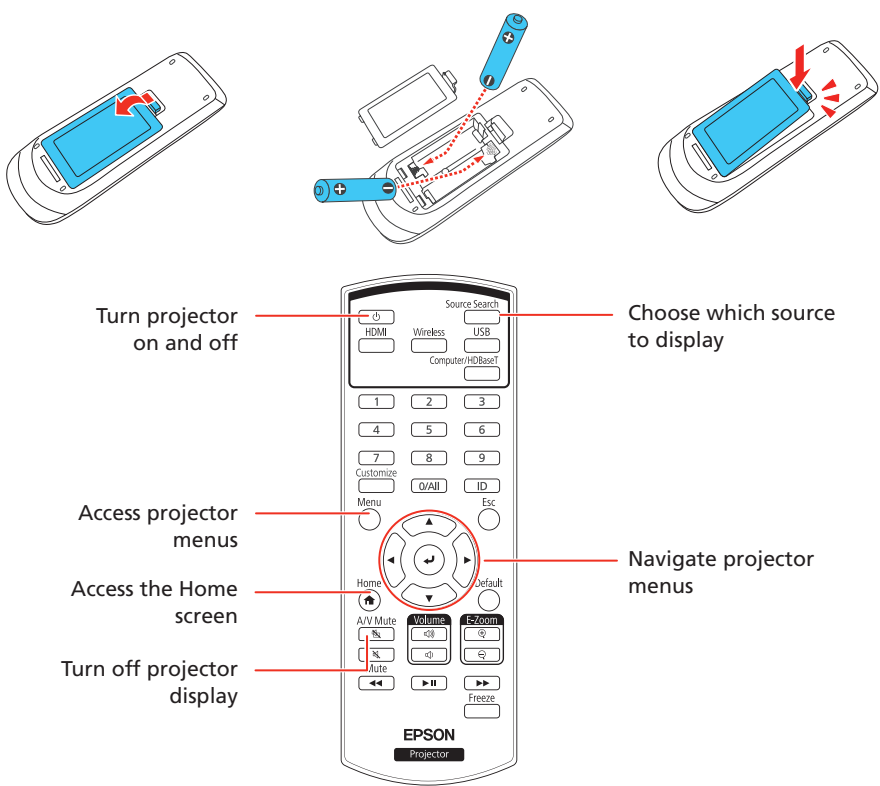

For more information on using the remote control, see the online *User's Guide*.

Turn on your equipment

- 1 Plug in the projector. The power light on the projector turns blue.

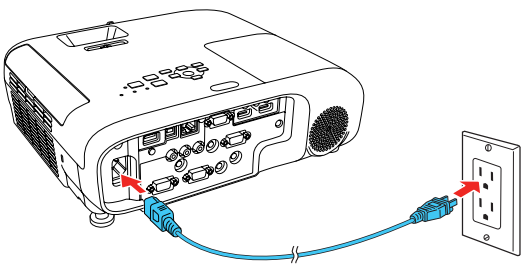

- 2 Open the A/V Mute slide all the way.

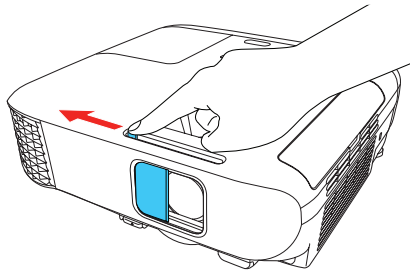

- 3 Press the power button on the projector or remote control. The projector beeps, the Status light flashes blue, and then stays on.

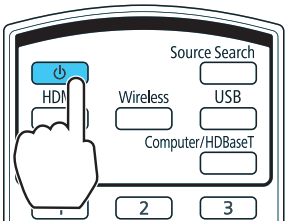

Note: *To shut down the projector, press the power button twice.*

- 4 Use the arrow and buttons on the projector or remote control to proceed with initial setup.

Note: *You can change these settings later using the projector's menus. For more information, see the online *User's Guide*.*

- 5 When initial setup is complete, turn on your computer or video source.

Adjust the image

- 1 If you don't see an image, press the **Source Search** button on the projector or remote control to select the image source.

Note: *If you still see a blank screen or have other display problems, see "Troubleshooting."*

- 2 To raise the image, press the foot release button and lift the front of the projector. Release the button to lock the foot in position.

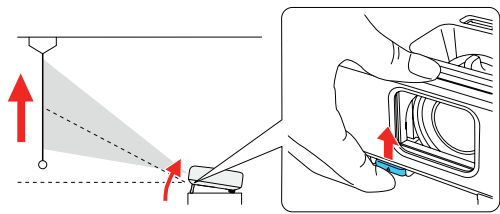

- 3 To reduce or enlarge the image, turn the zoom ring.

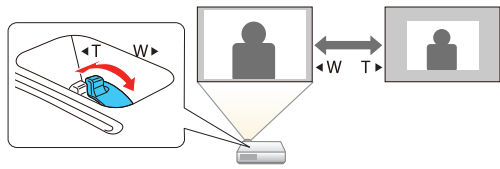

- 4 To sharpen the image, turn the focus ring.

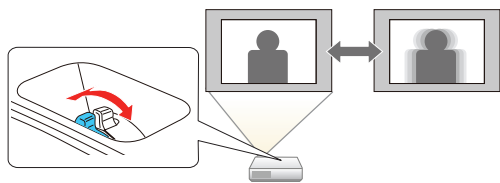

- 5 If your image looks like or , you may have placed the projector off to one side of the screen at an angle. Place the projector directly in front of the center of the screen, facing the screen squarely.

- 6 If you can't move the projector, use the horizontal keystone slider on the projector to correct the image shape.

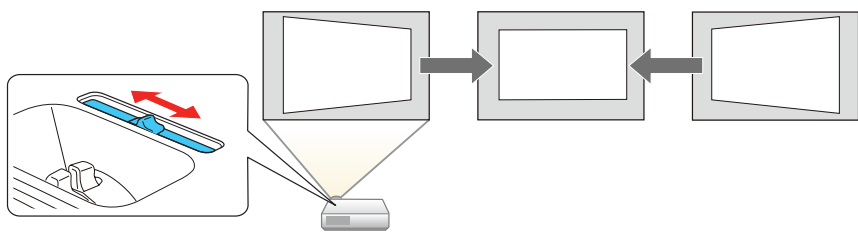

- 7 Your projector automatically adjusts an image that looks like or , but if necessary, you can press the or button on the projector to correct it.

Setting up a wireless connection

Follow these steps to set up the projector for a wireless network connection.

- 1 Press the **Menu** button on the remote control.
- 2 Select the **Network** menu and press .
- 3 Make sure the **Wireless LAN Power** setting is set to **On**.
- 4 Select **Network Configuration** and press .

- 5 Select the **Wireless LAN** menu and press .

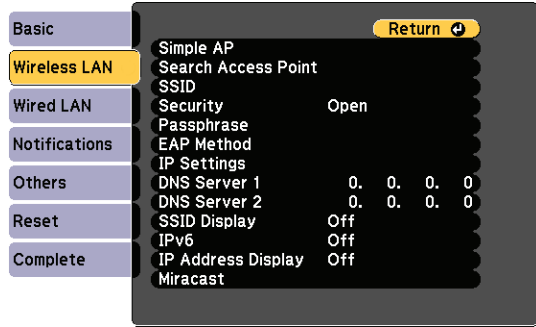

- 6 Select one of the following as the **Simple AP** setting:

- **On** for a direct connection to a computer, tablet, or smartphone.

Note: *If you are prompted to set a passphrase, follow the on-screen instructions.*

- **Off** to connect your projector to a router or access point.

- 7 Select any other settings on the Wireless LAN menu, as necessary. See the online *User's Guide* for details.

- 8 When you are finished, select **Complete** and follow the on-screen instructions to save your settings and exit the menus.

Note: *If you are prompted to enter a password for Epson Web Control, you can create a password or leave it blank. If you do not set a password, you cannot use Epson Web Control.*

Install the optional software

You can use Epson iProjection™ software to display wirelessly from a computer to your networked projector. Download the software and operation guide from your product's support page (see "Where to get help") and install the program on each computer that will project over the network.

To monitor and control your projector over the network, download and install the Epson Projector Management software (Windows® only) and operation guide from your product's support page (see "Where to get help").

Using web control

You can use a standard web browser to control the projector through the network. A virtual remote control on your computer or mobile device screen lets you perform many of the same functions as you can with the physical remote control.

- 1 Open your web browser and enter the IP address of the projector you want to monitor in the browser's address bar. The Epson Web Control menu opens.

If you're not sure what the IP address of the projector is, turn the projector on and select **Net. Info. - Wireless LAN** from the Network menu to display the IP address of the projector. (Do not enter the leading zeroes.)

- 2 Select **Basic Control** or **Remote**. If you see a login screen, enter **EPSONWEB** as the user name. If a password was created, enter the password.

- 3 Use the on-screen buttons to operate the projector, as you would using the remote control. See the online *User's Guide* for details.

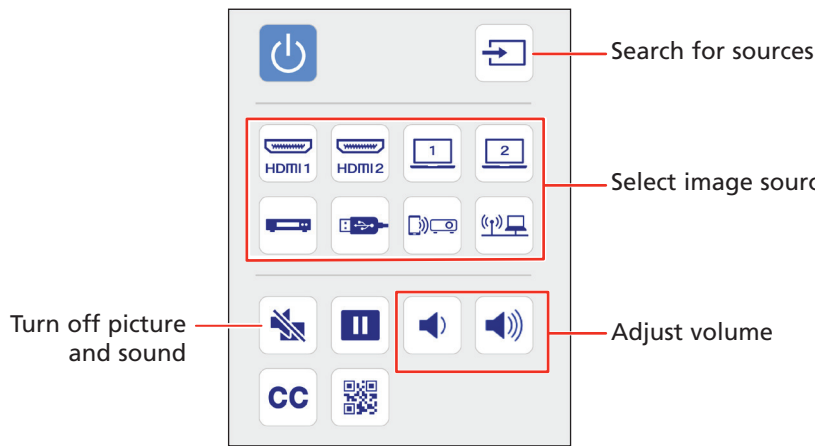

Using the Epson iProjection app

You can project wirelessly from a mobile device (iOS, Android™, or Chromebook™) using the Epson iProjection app and a QR code.

- 1 Scan the following QR code to download and install the Epson iProjection app.



- 2 If you connected the projector to a network wirelessly, make sure to connect your mobile device to the same network.
- 3 Press the **Wireless** button on the remote control to display a QR code on the projector screen.
- 4 Start Epson iProjection on your mobile device.
- 5 Use the QR code reader feature to read the QR code displayed.



Your device and the projector are connected.

For more information on setting up and using this app, visit <http://epson.com/projectorapp> (U.S.) or <http://epson.ca/projectorapp> (Canada).

Troubleshooting

- If you see a blank screen, check the following:
 - Make sure the A/V Mute slide is open.
 - Make sure the Status light on the projector is blue and not flashing.
 - Press the  power button or the **A/V Mute** button on the remote control to wake the projector from standby or sleep mode, if necessary.
- If you see a blank screen when a computer is connected, check the following:
 - On Windows, hold down the Windows key and press **P** at the same time, then click **Duplicate**.
 - If you are using a Mac laptop with macOS 13 or newer, select **System Settings > Displays**. Select the projector, then choose the mirror option for your display from the Use as pop-up menu.

On macOS 12, select **System Preferences > Displays > Display Settings**. Select the projector, then choose the mirror option for your display from the drop-down menu.

On macOS 11 and older, open **System Preferences** and select **Displays**. Click the **Arrangement** tab and select the **Mirror Displays** checkbox.
- If the projector does not respond to remote control commands, make sure the batteries in the remote control are installed correctly. Replace the batteries if necessary.
- If you are unable to project from a device with a wireless connection, make sure the projector and your device are on the same network. See your product's online *User's Guide* for more information.

Registration

Scan the QR code to register for product updates and exclusive offers.



Where to get help

Manuals

For more information about using the projector, you can view or download the manuals from the Epson website, as described below.

Internet support

Visit <http://epson.com/support> (U.S.) or <http://epson.ca/support> (Canada) and search for your product to download software and utilities, view manuals, get FAQs and troubleshooting advice, or contact Epson.

Telephone support

To use the Epson PrivateLine™ Support service, call (800) 637-7661. This service is available for the duration of your warranty period. You may also speak with a support specialist by calling (562) 276-4394 (U.S.) or (905) 709-3839 (Canada).

Support hours are 7 a.m. to 4 p.m., Pacific Time, Monday through Friday. Days and hours of support are subject to change without notice. Toll or long distance charges may apply.

Optional accessories

For a list of optional accessories, see the online *User's Guide*.

You can purchase screens or other accessories from an Epson-authorized reseller. To find the nearest reseller, call 800-GO-EPSON (800-463-7766). Or you can purchase online at <http://epsonstore.com> (U.S. sales) or <http://epsonstore.ca> (Canadian sales).

Notices

Wireless Product Safety Instructions

Contains WLAN / BT module model: NH7

This document provides safety instructions and describes the specifications. Read this document carefully before use to ensure your safety and product performance.

This device is restricted to indoor operation only.

Operating frequency range: 2.402-2.480GHz, 5.18-5.24GHz, 5.26-5.32GHz, 5.50-5.72GHz, 5.745-5.825GHz, 5.845-5.885GHz, 5.955-7.115GHz

Data transmission is always initiated by software, which is then passed down through the MAC, through the digital and analog baseband, and finally to the RF chip. Several special packets are initiated by the MAC. These are the only ways the digital baseband portion will turn on the RF transmitter, which it then turns off at the end of the packet. Therefore, the transmitter will be on only while one of the aforementioned packets is being transmitted. In other words, this device automatically discontinue transmission in case of either absence of information to transmit or operational failure.

U.S. FCC Notices

Contains FCC ID: BKMAE-NH7

This device complies with Part 15 of the FCC Rules. Operation is subject to the following two conditions: (1) This device may not cause harmful interference, and (2) this device must accept any interference received, including interference that may cause undesired operation. This equipment has been tested and found to comply with the limits for a Class B digital device, pursuant to Part 15 of the FCC Rules. These limits are designed to provide reasonable protection against harmful interference in a residential installation. This equipment generates, uses, and can radiate radio frequency energy and, if not installed and used in accordance with the instructions, may cause harmful interference to radio communications. However, there is no guarantee that interference will not occur in a particular installation. If this equipment does cause harmful interference to radio or television reception, which can be determined by turning the equipment off and on, the user is encouraged to try to correct the interference by one or more of the following measures:

- Reorient or relocate the receiving antenna.
- Increase the separation between the equipment and receiver.
- Connect the equipment into an outlet on a circuit different from that to which the receiver is connected.
- Consult the dealer or an experienced radio/TV technician for help.

Caution: Changes or modifications not expressly approved by the party responsible for compliance could void the user's authority to operate this equipment. Properly shielded and grounded cables and connectors must be used for connection to host computers and/or peripherals in order to meet FCC emission limits.

This transmitter must not be co-located or operating in conjunction with any other antenna or transmitter.

This equipment complies with FCC radiation exposure limits set forth for an uncontrolled environment and meets the FCC radio frequency (RF) Exposure Guidelines.

This equipment should be installed and operated keeping the radiator at least 7.8 inches (20 cm) or more away from person's body.

Innovation, Science and Economic Development Canada (ISED) Notices

Contains IC: 1052D-NH7

CAN ICES(B)/NMB(B)

This device contains license-exempt transmitter(s)/receiver(s) that comply with Innovation, Science and Economic Development Canada's license-exempt RSS(s). Operation is subject to the following two conditions: (1) This device may not cause interference. (2) This device must accept any interference, including interference that may cause undesired operation of the device.

This equipment (without Bluetooth® remote controller) complies with ISED radiation exposure limits set forth for an uncontrolled environment and meets RSS-102 of the ISED radio frequency (RF) Exposure rules. This equipment should be installed and operated with a distance of at least 7.9 inches (20 cm) between the radiator and your body.

EPSON®



EPSON, PowerLite, and the 3LCD logo are registered trademarks and iProjection is a trademark of Seiko Epson Corporation.

PrivateLine is a trademark of Epson America, Inc.

Mac, macOS, and OS X are trademarks of Apple Inc., registered in the U.S. and other countries.

Android and Chromebook are trademarks of Google LLC.

Windows is a trademark of the Microsoft group of companies.

General Notice: Other product names used herein are for identification purposes only and may be trademarks of their respective owners. Epson disclaims any and all rights in those marks.

This information is subject to change without notice.

© 2024 Epson America, Inc., 11/24
Printed in XXXXXX

CPD-65243